

Shuresafe® Model 672319 Thru-Wall Cash Drawer

Product Description



- ✓ Features a removable stainless steel deal tray for money and credit card transactions.
- ✓ Removing the deal tray exposes a large transfer area for bulkier convenience items.
- ✓ Push button handle incorporates a self-contained locking mechanism for user safety.
- ✓ Contains a lockable cash tray with a forward-hinged cover that conceals the cash tray from customer view.
- ✓ Rear of transfer area fits against frame when drawer is open offering increased operator safety.
- ✓ Units are finished in brushed stainless steel and shipped with some assembly required.

FRONT VIEW

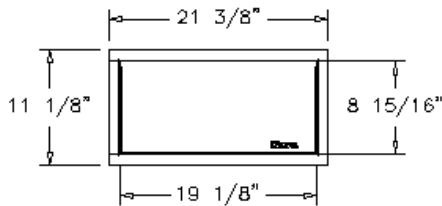

TOP VIEW

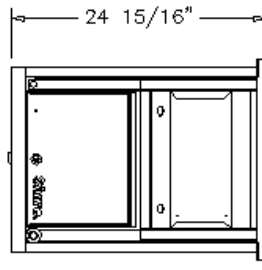

SIDE VIEW

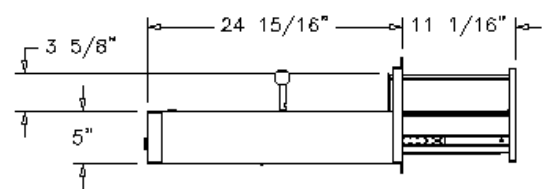

| Model | Overall Size | | | Frame Face | | Transfer Area | | | Wall Opening | | Wt. | Features |
|--------|--------------|--------|-----------|------------|---------|---------------|--------|--------|--------------|--------|---------|------------------|
| | W | H | L | W | H | W | H | L | W | H | | |
| 672319 | 18" | 8 5/8" | 24 15/16" | 21 3/8" | 11 1/8" | 13 3/4" | 7 7/8" | 9 5/8" | 19 11/16" | 9 1/2" | 78 lbs. | Cash Compartment |

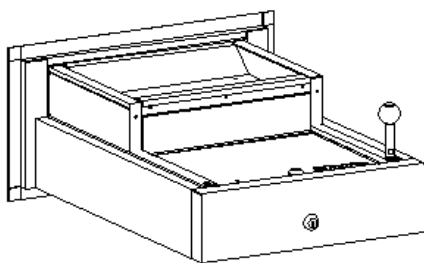

OPERATOR SIDE

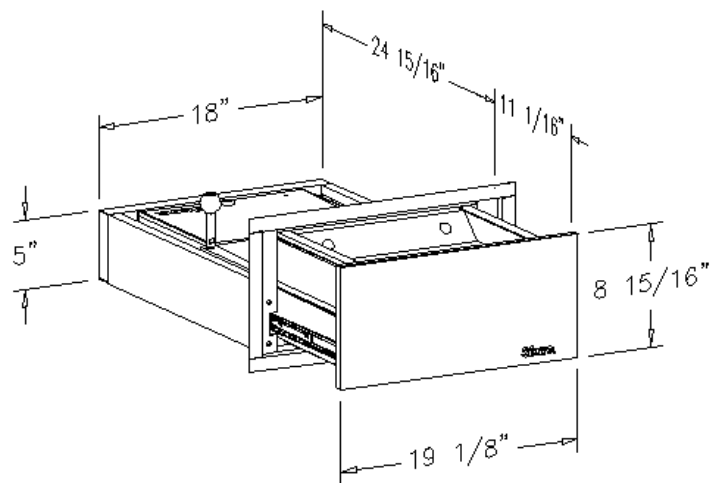

CUSTOMER SIDE